

WPA-CHEM – radial fan



Purpose

Radial fans, type WPA-CHEM are adapted for conveying the clean air or the air polluted with chemically aggressive media (see tables on pages 66–67) of maximum dustiness concentration up to $0,3 \text{ g/m}^3$ and temperature $+40^\circ\text{C}$. The fans can be applied in ventilation systems (air supply and extraction) in industry, agriculture, building construction, chemical industry, as well as in buildings of public services as: laboratories, store houses, hospitals, schools, canteens, swimming pools, sewage treatment plants etc. The fans carry the certificate of the National Institute of Public Health of National Institute of Hygiene. The fans meet the requirements of the ErP 2009/125/EC Directive.

Structure

The appliance consists of a spiral housing of non-plasticised polyvinyl chloride and a motor. The radial impeller (also of non-plasticised polyvinyl chloride) is directly fastened at the motor shaft. The fan motor is mounted on a steel angle bar base. Between the base and motor are placed special rubber washers to reduce vibrations transmitted onto the base and building elements. Within the lower parts of the base, there are mounting holes.

For safety reasons, the fan inlet and outlet are equipped with protective grills, fastened depending on the purpose of use, work mode. The fans are delivered in outlet location RD 0 (see scheme).

On demand of Customer, we deliver fans of another outlet placement.

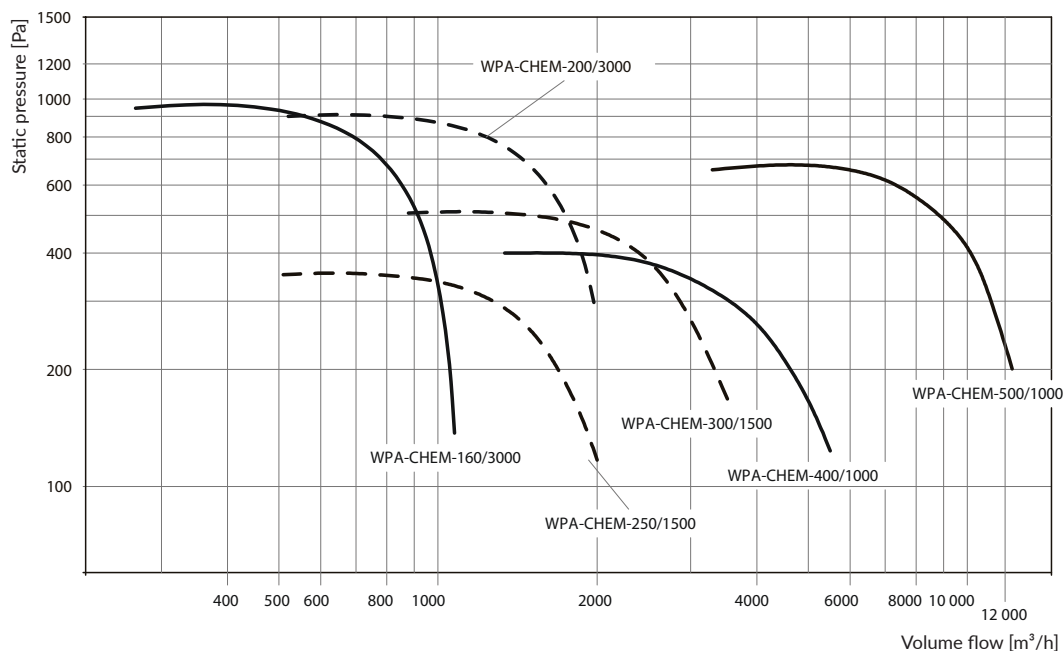

Technical data

Type	Part no.	Synchronous rotations [1/min]	Supply voltage [V]	Motor rate [kW]	Ingress protection IP	Maximum volume flow [m³/h]	Maximum vacuum [Pa]	Acoustic pressure level [dB(A)] from a distance of:		Weight [kg]
								1 m	5 m	
WPA-CHEM-160/3000	802W06	3000	3x400	0,37	55	1100	950	71	62	14
WPA-CHEM-200/3000	802W07	3000	3x400	0,55	55	2000	900	72	63	25
WPA-CHEM-250/1500	802W08	1500	3x400	0,25	55	2000	350	64	56	30
WPA-CHEM-300/1500	802W09	1500	3x400	0,55	55	3500	530	68	59	36
WPA-CHEM-400/1000	802W10	1000	3x400	0,55	55	5500	400	68	59	60
WPA-CHEM-500/1000	802W11	1000	3x400	2,2	55	12 200	720	75	66	107

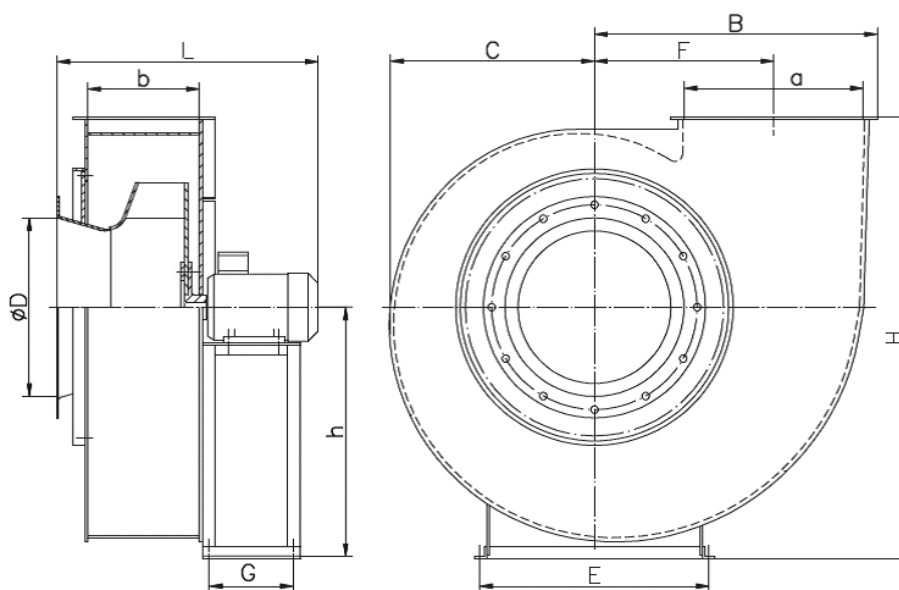

Dimensions*

Type	D [mm]	a [mm]	b [mm]	h/RD 0 [mm]	F [mm]	C [mm]	G [mm]	E [mm]	L [mm]	H [mm]	B [mm]
WPA-CHEM-160/3000	160	162	118	263	188	202	150	218	385	501	310
WPA-CHEM-200/3000	200	237	133	326	224	240	370	278	510	568	381
WPA-CHEM-250/1500	250	297	166	398	280	297	405	308	545	698	473
WPA-CHEM-300/1500	300	356	199	482	336	358	440	414	620	848	557
WPA-CHEM-400/1000	400	474	265	617	447	470	580	514	680	1080	728
WPA-CHEM-500/1000	500	500	315	715	500	570	640	640	730	1235	788

* The above mentioned dimensions are referring to the fans of outlet placement RD 0.

Location of outlet

