

## BOX-CHEM – duct fan



### Purpose

Generally, radial fans, type BOX-CHEM are designed for conveying the clean air or the air polluted with chemically aggressive media (see tables on pages 66–67) of maximum dustiness concentration up to  $0,3 \text{ g/m}^3$  and temperature  $+40^\circ\text{C}$ . The fans are applied within ventilation systems in various fields in industry, especially in buildings for ventilation of rooms, store houses and various types of halls. Due to their construction, they can be installed directly between square-cross-section ventilation ducts, not changing the medium flow direction. The fans meet the requirements of the ErP 2009/125/EC Directive.

### Structure

The box-shape fan housing consists of non-plasticised polyvinyl chloride plates. The conveyed medium is drawn in, at one housing side, through the inlet duct of the housing. Subsequently, the air stream flows through the inlet confusor onto the impeller, then to the spiral housing and directly to the outlet duct (of the housing) afterwards. The fan motor is fixed (through a flange) on the supporting plate of non-plasticised polyvinyl chloride and further to the housing. The conveyed medium do not contact the motor. The impeller is also of non-plasticised polyvinyl chloride. The fan inlet and outlet, are equipped with square flanges, to install the fan between the square section ventilation ducts.

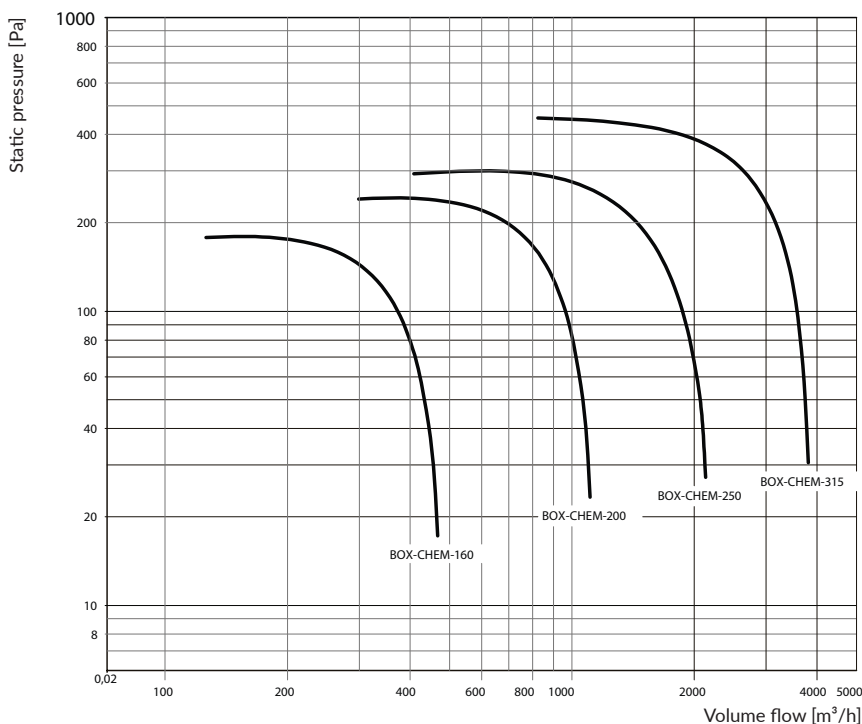

## Technical data

Type	Part no.	Synchronous rotations [1/min]	Supply voltage [V]	Motor rate [kW]	Ingress protection IP	Maximum volume flow [m³/h]	Maximum vacuum [Pa]	Acoustic pressure level [dB(A)] from a distance of:		Weight [kg]
								1 m	5 m	
BOX-CHEM-160/1500	802W12	1500	230	0,12	55	460	170	56	48	13,2
BOX-CHEM-200/1500	802W13	1500	230	0,18	55	1150	230	62	35	22
BOX-CHEM-250/1500	802W14	1500	230	0,25	55	2100	300	65	57	26
BOX-CHEM-315/1500	802W15	1500	230	0,75	55	3820	460	70	62	40

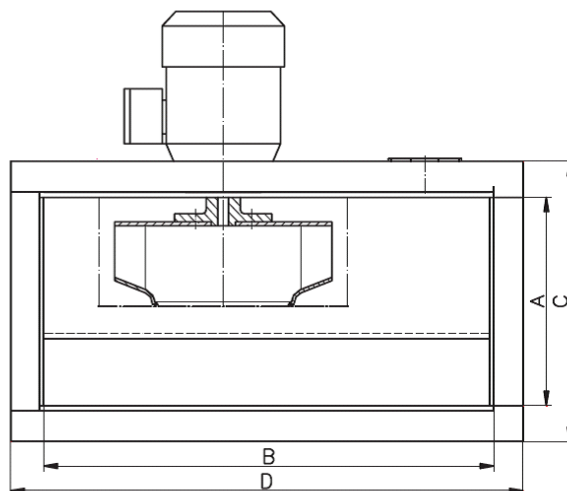
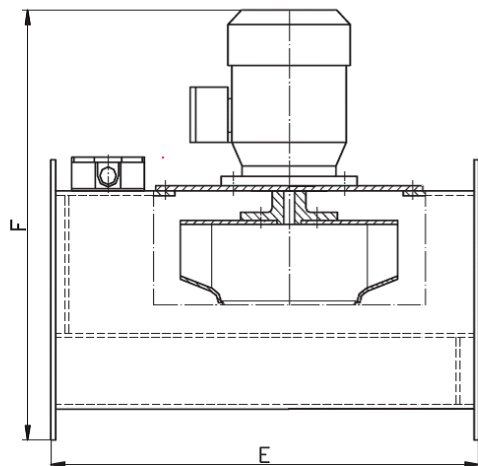

## Dimensions

Type	A [mm]	B [mm]	C [mm]	D [mm]	E [mm]	F [mm]
BOX-CHEM-160/1500	228	460	298	530	441	458
BOX-CHEM-200/1500	265	577	335	647	545	495
BOX-CHEM-250/1500	350	721	420	791	665	583
BOX-CHEM-315/1500	448	819	530	900	800	733